

JB Conduit Outlet Boxes, Covers and Hangers

UNILETS™ for use with Threaded Rigid Metal Conduit and IMC. Furnished with Internal Ground Screw.

NEC:
Listed for Ordinary Locations

COMMERCIAL AND INDUSTRIAL FITTINGS: CONDUIT OUTLET BODIES

Applications

- Serve as pulling fittings.
- Provide openings for splicing.
- Make straight connections and 90° bends in conduit runs.
- Permit access to conductors for maintenance.

Features

- Raintight when enclosed and gasketed with hub or blank covers.
- Furnished with internal ground screw.
- Blind cover screw holes prevent conductor damage during installation, provide water-tightness.
- Available in three inside depths: 1-5/16", 2-1/16", and 3-1/8".
- Order with or without mounting lugs.
- Furnished with four tapped holes and two close-up plugs.
- Cushion fixture hangers are enclosed and gasketed.

Standard Materials





- JB conduit outlet boxes and covers and JB fixture hangers: malleable iron
- JB-A boxes and covers: copperfree (4/10 of 1% max.) aluminum
- Gaskets: neoprene

Standard Finishes

- Malleable iron conduit outlet boxes, and hub covers: triple-coat — (1) zinc electroplate, (2) chromate and (3) epoxy powder coat
- Fixture hangers, JB 1/2" hub and blank covers: triple-coat — (1) zinc electroplate, (2) chromate and (3) epoxy powder coat
- Aluminum JB conduit outlet boxes: epoxy powder coat

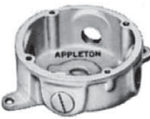
NEC Certifications and Compliances

- UL Standard: 514A
- UL Listed: E2527
- NEMA Standard: FB-1





	Description	Hub Size (Inches)	Catalog Number	
			Malleable Iron	Aluminum
JBX — 1-5/16" Inside Depth — Furnished with four tapped openings and two close-up plugs				
	Less mounting lugs	1/2	JBX-50	—
		3/4	JBX-75	—
		1	JBX-100	—
	With mounting lugs	1/2	JBX-50L	JBX50L-A
		3/4	JBX-75L	JBX75L-A
		1	JBX-100L	—
JBDX — 2-1/16" Inside Depth — Furnished with four tapped openings and two close-up plugs				
	Less mounting lugs	1/2	JBDX-50	—
		3/4	JBDX-75	—
		1	JBDX-100	—
	With mounting lugs	1/2	JBDX-50L	—
		3/4	JBDX-75L	—
		1	JBDX-100L	—
JBLX — 3-1/8" Inside Depth — Furnished with four tapped openings and two close-up plugs				
	With removable mounting lugs	1/2	JBLX-50L	JBLX-50L-A
		3/4	JBLX-75L	JBLX-75L-A
		1	JBLX-100L	JBLX-100L-A

JB Conduit Outlet Boxes, Covers and Hangers

UNILETS™ for use with Threaded Rigid Metal Conduit and IMC.

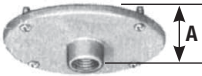
NEC:

Listed for Ordinary Locations

Description	Hub Size (Inches)	Depth in Millimeters (Inches) (A)	Catalog Number	
			Malleable Iron	Aluminum
Cast Covers — Furnished with screws — When used with gasket provides raintight fit, supports 113.4 kg (250 lb)				
 Hub Covers	1/2	20.0 (0.75)	JBK-50	JBK-50-A
	3/4	23.9 (0.94)	JBK-75	JBK-75-A
 Cover	Blank	4.8 (0.19)	JBK-B	JBK-1B-CA
Gasket — Neoprene				
	—	—	JB-GK-N	JB-GK-N
Flexible Fixture Hangers — Furnished with gasket and screws				
 Ball Type — 15° swing in all directions, support 113.4 kg (250 lb)	1/2	65.0 (2.56)	JBK-50-BS	—
	3/4	65.0 (2.56)	JBK-75-BS	—
 Cushion type, enclosed and gasketed — 8° swing in all directions. Cushions 18.1 kg (40 lb), supports 113.4 kg (250 lb)	1/2	41.4 (1.63)	JBK-50-CS	—
	3/4	41.4 (1.63)	JBK-75-CS	—

Dimensions in Millimeters (Inches)

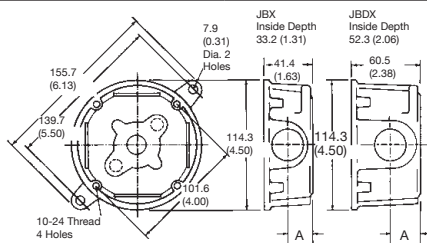

JBX, JBDX

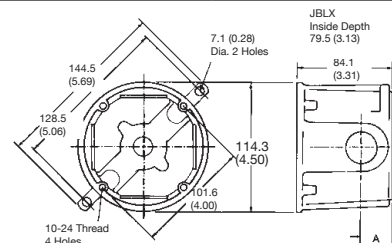

JBLX

Hub Size (Inches)	Dimension "A" in Millimeters (Inches)		
	JBX	JBDX	JBLX
1/2	19.1 (0.75)	19.1 (0.75)	19.1 (0.75)
3/4	22.4 (0.88)	22.4 (0.88)	22.4 (0.88)
1	20.6 (0.81)	26.9 (1.06)	26.9 (1.06)

Wiring Capacity ①

Hub Size (Inches)	dm ³ (in ³)		
	JBX	JBDX	JBLX
1/2	15.50 (0.25)	23.00 (0.38)	33.00 (0.54)
3/4	15.50 (0.25)	23.00 (0.38)	33.00 (0.54)
1	15.50 (0.25)	23.00 (0.38)	33.00 (0.54)

① JB covers add no additional cubic inch capacity.